

1

VERSARACK VAN RACKING SYSTEMS ASSEMBLY INSTRUCTIONS

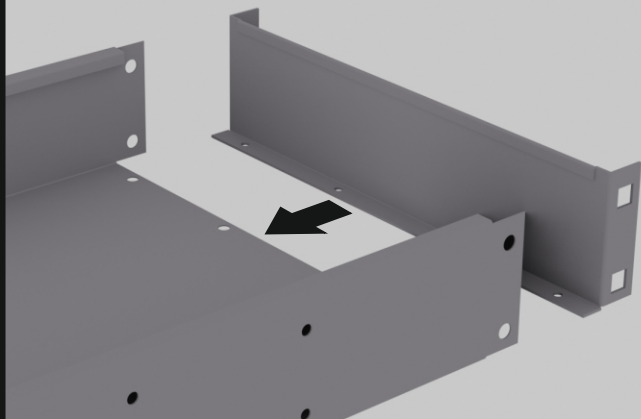

PLEASE ENSURE THAT THE LIP ON THE END PANEL GOES UNDERNEATH THE SHELF PANEL

2

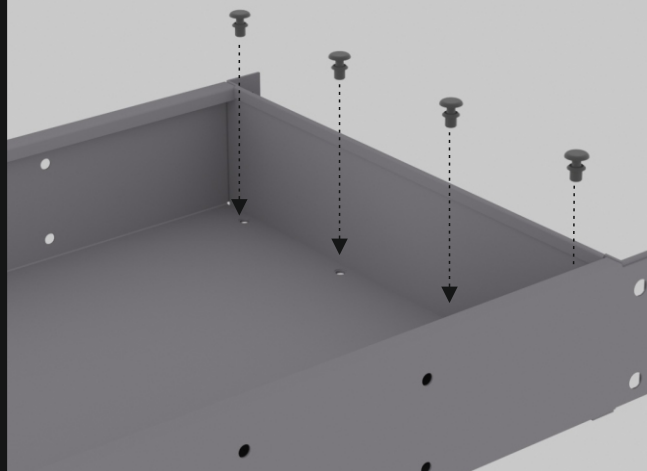

PRESS HOME THE BLACK NYLON PUSH RIVETS THROUGH THE LINED UP HOLES REPEAT ON ALL SHELVES / BOTH ENDS

3

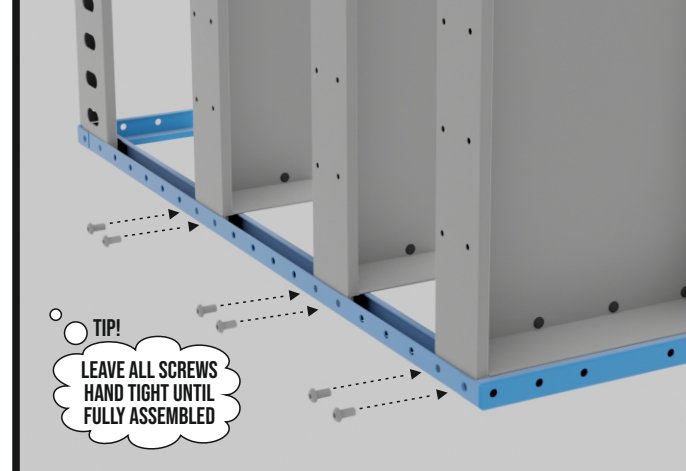

LIE BLUE END FRAME ON FLAT SURFACE AND AFFIX SHELVES FRONT AND BACK WITH M8 X 16MM DOME HEAD BOLTS

4

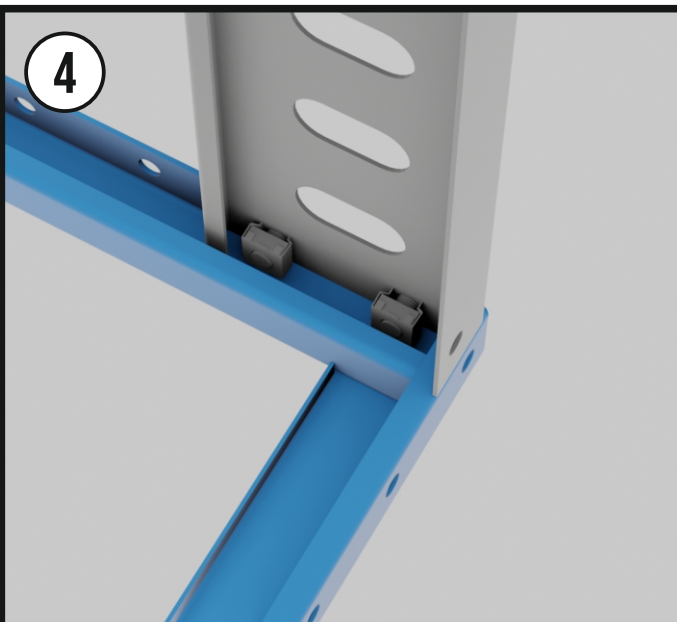

AFFIX THE KICK / LASHING PLATE USING M8 X 16MM DOME HEAD BOLTS INTO PRE-FIXED CAGE NUTS

5

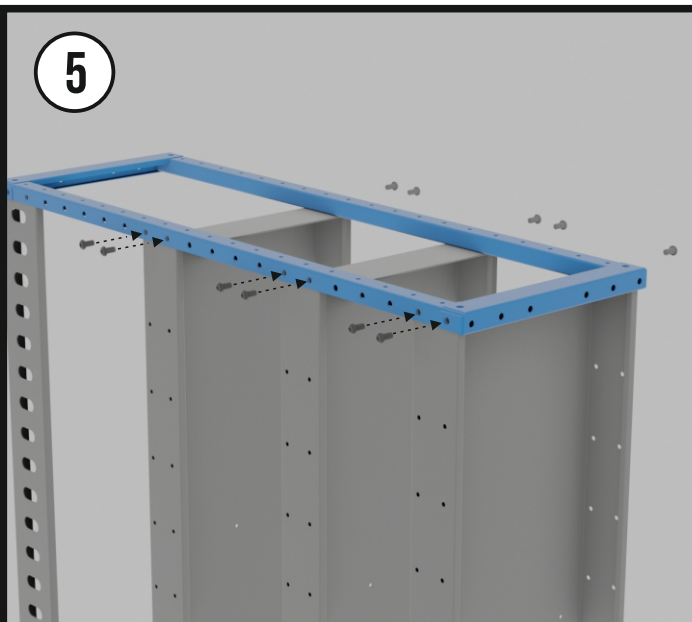

PLACE ON TOP OTHER BLUE END FRAME AND REPEAT THE FIXINGS PROCEDURE AS FIG. 3 & FIG. 4

6

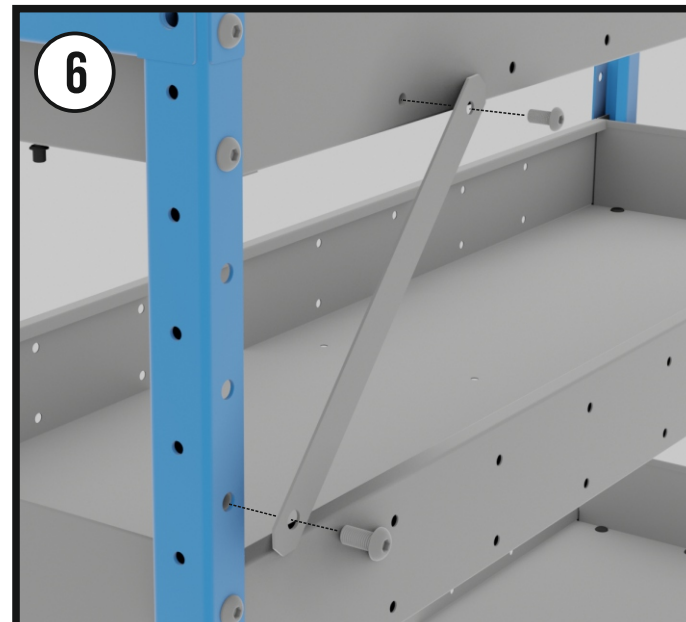

AFFIX REAR BRACES IF REQUIRED TO ADD EVEN MORE STRENGTH USING M6 DOME HEAD BOLTS & NYLOCKS